



**ICV 951 Flowmaster 3-in-1 PICV for terminal units in 0-90°C HVAC systems (fancoils and air handling units). Especially suitable for variable flow systems with frequently changing loads or DP. The 3-in-1 PICV set combines motorized control, dynamic differential pressure balancing and static balancing (max flow setting).  
Flanges and drilling to BS EN 1092-2**

**Use:**

For water to max. 95°C

**Tests:**

Hydraulic test to BS EN 12266  
Seat: According to each aperture closure pressure difference.  
The allowable leakage rate: Max flow\*0.05%  
Body: 1.5 x PN

**Marking:**

Body: ICV Nameplate. DN, PN, and flow direction.  
Actuator: ICV logo, Wiring diagram, Voltage value.

**Materials**

Body Cast iron GG25  
Stem Stainless steel AISI 304  
Diaphragm EPDM  
Internals Brass

**Actuating**

Power supply 24VAC±10% 50/60HZ  
Power cons 12 W  
Control signal 0-10V/2-10V/0-20mA/4-20mA  
Feedback signal 0-10V/2-10V  
Actuating force 1000 N (DN40-80)  
3000 N (DN100-125)  
5000 N (DN150-200)  
Running time 50HZ,105s/60HZ,90s(DN40-80)  
50HZ,180s/60HZ,150s(DN100-125)  
50HZ,240s/60HZ,175s(DN150-200)  
Protection grade IP54  
Ambient temp -10~50°C

LCD display feedback signal or max opening setting



DN40-125



DN150-200



ICV 951 Flowmaster 3-in-1 PICV for terminal units in 0-90°C HVAC systems (fancoils and air handling units). Especially suitable for variable flow systems with frequently changing loads or DP. The 3-in-1 PICV set combines motorized control, dynamic differential pressure balancing and static balancing (max flow setting). Flanges and drilling to BS EN 1092-2

**Component list**

- |              |              |         |
|--------------|--------------|---------|
| 1. Spring    | 3. Body      | 5. Stem |
| 2. Diaphragm | 4. Cartridge |         |

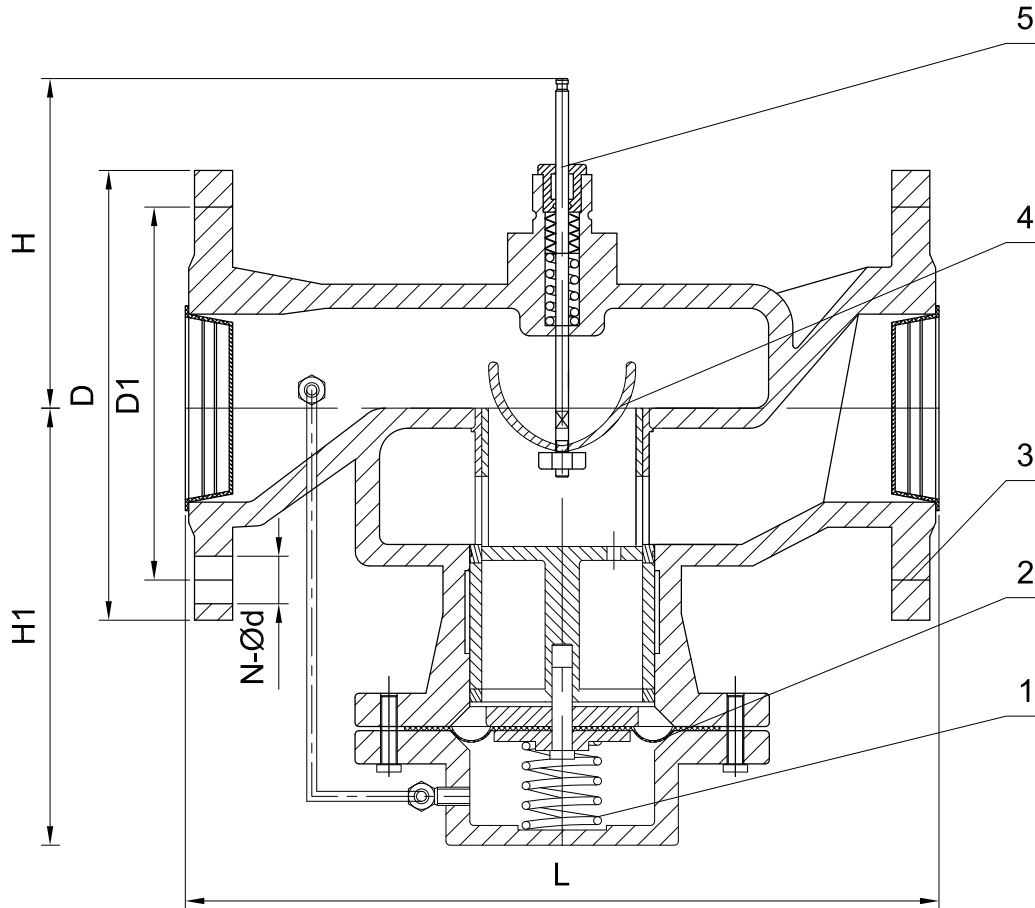

Ref.no.	DN	L mm	D mm	D1 mm	N-Ød	H mm	H1 mm	Flow rate* m <sup>3</sup> /h	DP range KPa	Closing pressure Kpa	Weight Kgs
9510040151	40	200	145	110	4-Φ18	150	140	1.0~7.7	30~400	500	12.2
9510050151	50	230	160	125	4-Φ18	166	164	2.0~12.1	30~400	400	16.6
9510065151	65	290	180	145	4-Φ18	178	204	3.0~20.4	30~400	350	23
9510080151	80	310	195	160	8-Φ18	182	219	5.0~40.0	30~400	200	28
9510100151	100	350	215	180	8-Φ18	207	241	10.0~45.3	30~400	400	45
9510125151	125	400	245	210	8-Φ18	218	276	15.0~70.7	30~400	200	62
9510150151	150	480	280	240	8-Φ23	234	337	20.0~101.8	30~400	150	86
9510200151	200	600	335	295	12-Φ23	259	403	50.0~360.0	30~400	150	153

\* Flow tolerance allowed: ≤5%.



ICV 951 Flowmaster 3-in-1 PICV for terminal units in 0-90°C HVAC systems (fancoils and air handling units). Especially suitable for variable flow systems with frequently changing loads or DP. The 3-in-1 PICV set combines motorized control, dynamic differential pressure balancing and static balancing (max flow setting). Flanges and drilling to BS EN 1092-2

Actuator

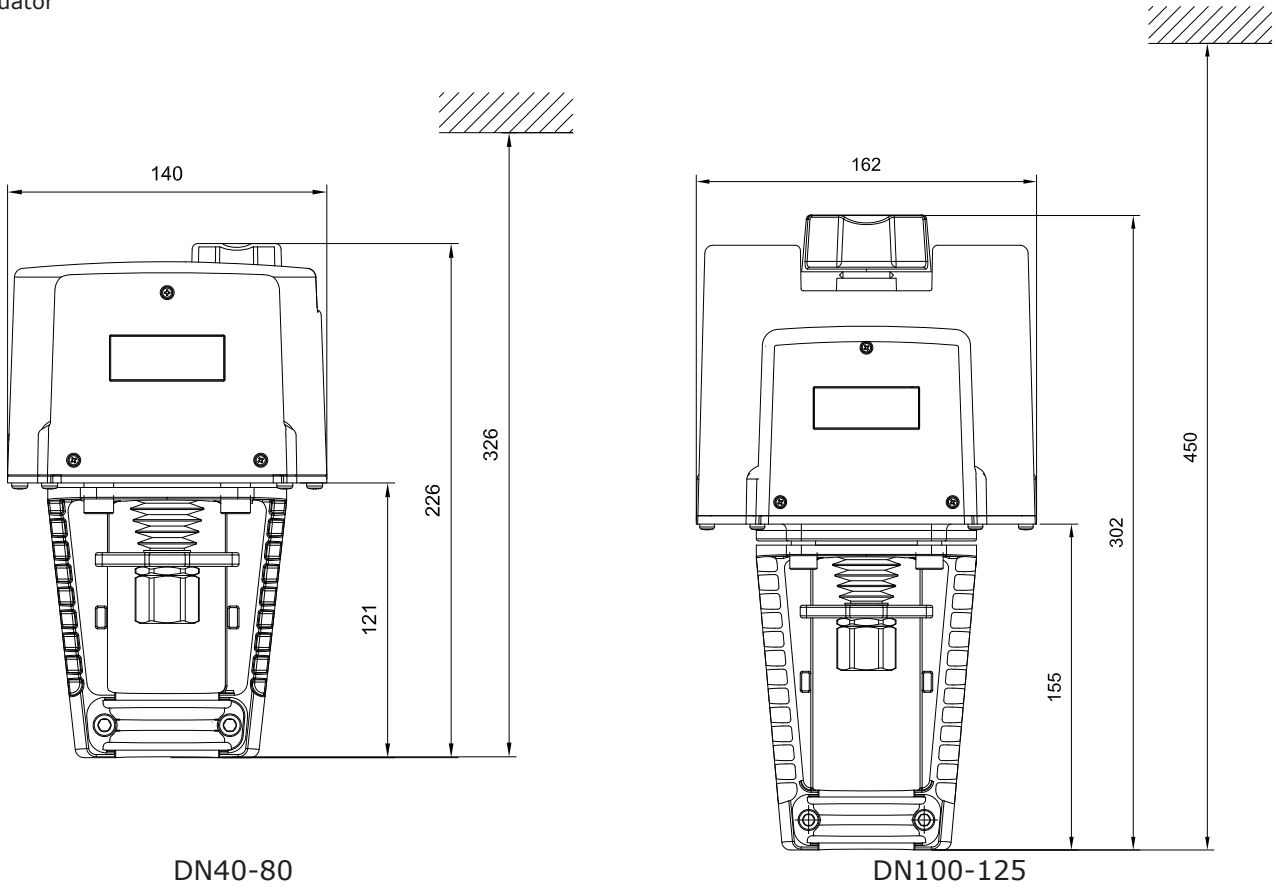

DN40-80

DN100-125

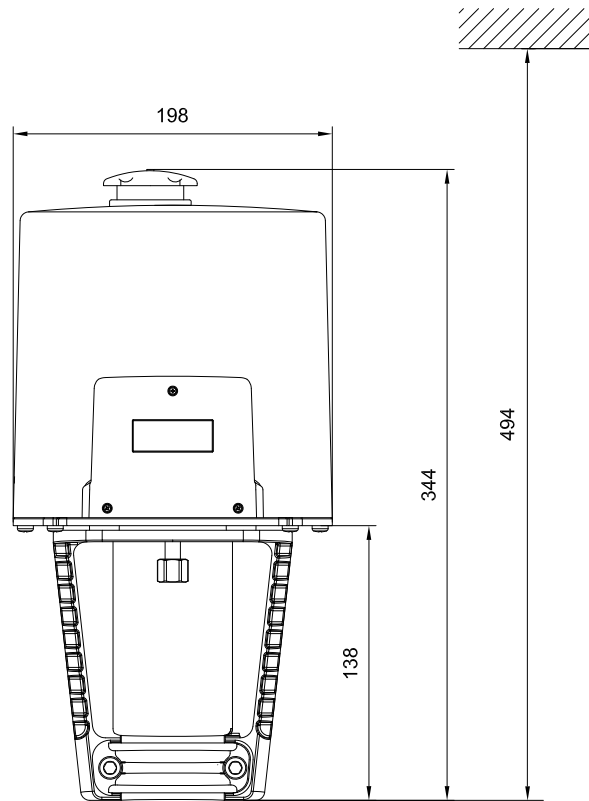

DN150-200



**ICV 951 Flowmaster 3-in-1 PICV for terminal units in 0-90°C HVAC systems (fancoils and air handling units). Especially suitable for variable flow systems with frequently changing loads or DP. The 3-in-1 PICV set combines motorized control, dynamic differential pressure balancing and static balancing (max flow setting). Flanges and drilling to BS EN 1092-2**

Head loss chart

