

# BUTTERFLY VALVE (WAFER TYPE) WITH GEAR, PN16

## SALIENT FEATURES

- Design Standard IS 13095 / BS5155. Wafer Type
- Quarter Turn Gear Operated
- Stainless Steel Disc
- No Visible Leakage
- Till size 200mm Liner will be renewable & above 200mm Body molded rubber (EPDM)
- Compatible to sandwich between flanges as per ISO7005-1 (GB/T 9113)/IS 1538 (B16.5#150)1092-2.



## SPECIFICATIONS

Sizes	DN50-DN750
Nominal pressure	PN16
Medium Temperature	-10°C ~ +110°C Maximum
Body Material	Upto DN250 - Cast Iron DN300-DN750 – Ductile Iron
Stem Material	ASTM A276, GR SS 410
Leakage Rate	No visible leakage
Maximum Working Pressure	16 bar (PN16)
Medium Type	Water
<b>Test Pressure (Hydrostatic)</b>	
Shell Test pressure	24 Bar
Seat Test pressure	17.6 Bar

### a. Valve Size DN50 - DN200 with Gear Box Operator (PN16)

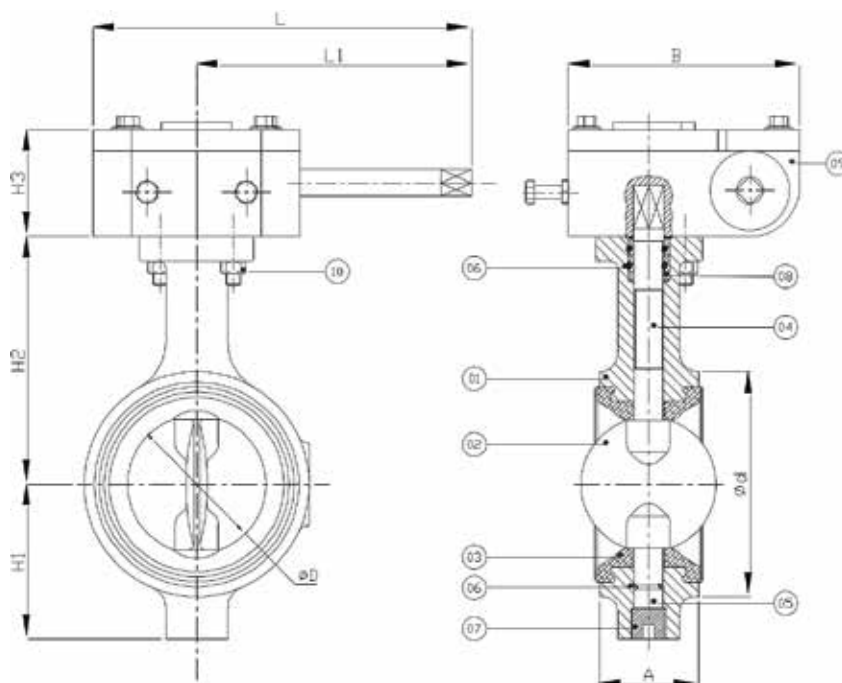

## PART DESCRIPTIONS

Part No.	1	2	3	4	5	6	7	8	9
Description	Body	Disc	Liner	Stem	O-Ring	Plug	Bush	Gear Box	Fastener
Material	Cast Iron	S.S.	Rubber	S.S.	Rubber	Mild Steel	Plastic	C.I. Casing	S.S.
Specifications	IS:210 Gr. FG200	S.S.	EPDM	ASTM A 276, Gr SS410	EPDM	M.S.	PTFE	Cast Iron	S.S.
Qty.	1	1	1	2	3	1	3	1	To Suite

## OUTSIDE DIMENSION (MM)

Valve Size	A	H1	H2	H3	L	L1	B	ØD	Ø d
50 (2")	41.5	67	110	60	182	115	112	52	97
65 (2-1/2")	44.5	74	118	60	182	115	112	65.5	111
80 (3")	44.5	83	127	60	182	115	112	80.5	128
100 (4")	50.5	100	145	60	182	115	112	100	160
125 (5")	54.5	119	161	60	182	115	112	122.5	192
150 (6")	54.5	132	174	60	182	115	112	146.5	213
200 (8")	58.5	161	238	60	182	115	112	196.3	271

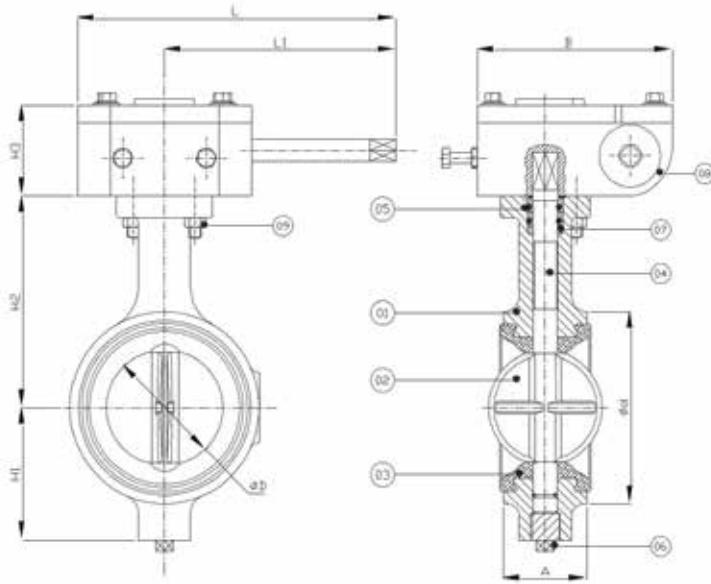

## PART DESCRIPTIONS

Part No.	1	2	3	4	5	6	7	8	9
Description	Body	Disc	Liner	Stem	O-Ring	Plug	Bush	Gear Box	Fastener
Material	Cast Iron	S.S.	Rubber	S.S.	Rubber	Mild Steel	Plastic	C.I. Casing	S.S.
Specifications	IS:210 Gr. FG200	S.S.	EPDM	ASTM A 276, Gr SS410	EPDM	M.S.	PTFE	Cast Iron	S.S.
Qty.	1	1	1	2	3	1	3	1	To Suite

## OUTSIDE DIMENSION (MM)

Valve Size	A±1.5	H1±1.5	H2±1.5	H3±1.5	L±1.5	L1±1.5	B±1.5	ØD±1.5	Ø d±1.5
250 (10")	66.5	204	282	60	180	130	110	252.6	326
300 (12")	76.5	229	307	60	180	130	110	300.2	378

c. Valve Size DN35 - 750 with Gear Box Operator (PN16)

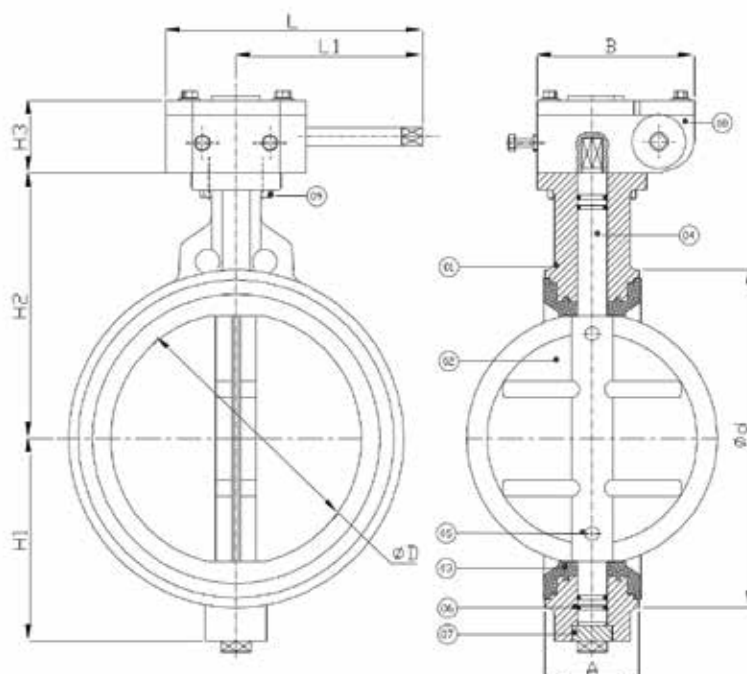

**PART DESCRIPTIONS**

Part No.	1	2	3	4	5	6	7	8	9
Description	Body	Disc	Liner	Stem	O-Ring	Plug	Bush	Gear Box	Fastener
Material	Cast Iron	S.S.	Rubber	S.S.	Rubber	Mild Steel	Plastic	C.I. Casing	S.S.
Specifications	IS:210 Gr. FG200	S.S.	EPDM	ASTMA 276, Gr SS410	EPDM	M.S.	PTFE	Cast Iron	S.S.
Qty.	1	1	1	1	3	1	3	1	To Suite

**OUTSIDE DIMENSION (MM)**

Valve Size	A±1.5	H1±1.5	H2±1.5t	H3±1.5	L±1.5	L1±1.5	B±1.5	ØD±1.5	Ø d±1.5
350 (14")	90.5	282	373	72	308	195	155	331	440
400 (14")	101.5	315	418	72	308	195	155	404.5	493
450 (18")	112.5	346	425	72	308	195	155	452	542
500 (20")	125.5	375	475	72	308	195	155	504	598
600 (24")	152.5	446	555	72	308	195	155	604	700
700 (28")	165	480	570	90	510	420	200	690	770
750 (30")	165	520	615	90	510	420	200	728	813

**For more information,**

www.honeywellbuildings.in  
 Call: 000-8000-502167,  
 Email: enquiry.mms@honeywell.com, bmsindiatechsupport@honeywell.com

**Honeywell HBT India Buildings**

Unitech Trade Center, 5th Floor, Sector-43,  
 Block C, Sushant Lok Phase - I,  
 Gurgaon - 122 002.

